

# Arkal 3" Twin Filter with a detachable spine

Catalog No. 1353 0 \_ \_ \_  
 1353 1 \_ \_ \_  
 1353 8 \_ \_ \_



## Features

- ◆ 3" - VIC, AK-flange, threaded inlet / outlet options.
- ◆ Non-corrosive.
- ◆ Detachable spine.
- ◆ Pressure differential disc compression.
- ◆ Robust design.
- ◆ High volume filter with increased flow capacity.
- ◆ Easy to open and close filter cover.
- ◆ Pressure testing ports are at the filters inlet and outlet.
- ◆ Available in various filtration grades.
- ◆ Drain valve.

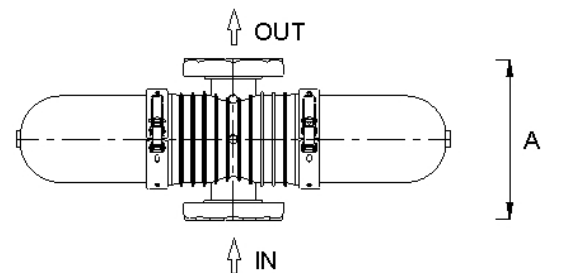
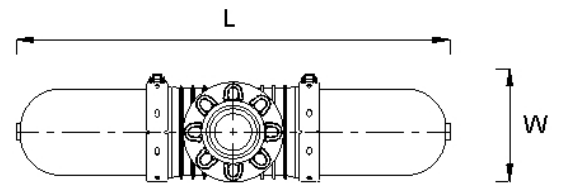

## Technical Data

Inlet/outlet diameter	3" / 80 mm BSPT (male)	3" BSPT (male)
	3" VICTAULIC 3" FLANGE	3" VICTAULIC 3" FLANGE
Maximum pressure	10 atm	145 psi
Flow rate:		
40-140 mesh (400-100 micron)	40 m <sup>3</sup> /h	176 gpm
55 micron	27 m <sup>3</sup> /h	119 gpm
20 micron	13 m <sup>3</sup> /h	57 gpm
General filtration area	1900 cm <sup>2</sup>	294 in <sup>2</sup>
Filtration volume	2450 cm <sup>3</sup>	158 in <sup>3</sup>
Filter width W	217 mm	8 9/16"
Filter length L	865 mm	34 1/16"
Distance between end connections A	320 mm	12 19/32"
Weight (flanged)	12.50 kg.	27.5 lbs
Weight (victaulic, threaded)	11 kg.	24.20 lbs
Maximum temperature	70° C	158° C
pH	5-11	5-11

## Filtration Grades

- Blue (400 micron / 40 mesh)
- Yellow (200 micron / 80 mesh)
- Red (130 micron / 120 mesh)
- Black (100 micron / 140 mesh)
- Green (55 micron)

## Head Loss Chart

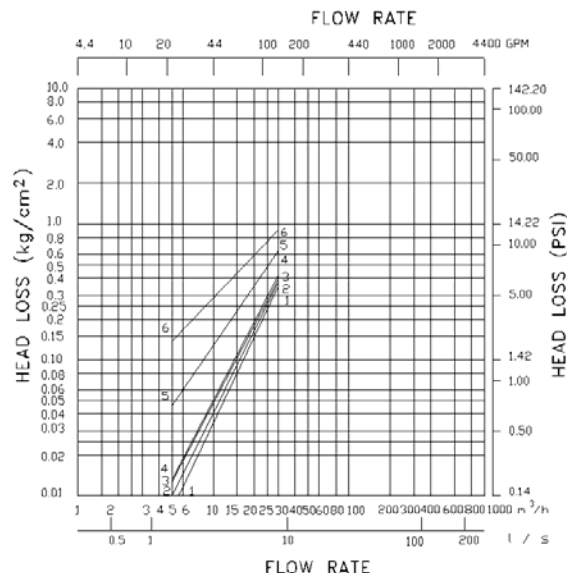

### Dismantling

1. Turn off water pressure.
2. If drain valve is at the bottom of the filter, open to drain.
3. Open clamp and remove filter cover from filter body.
4. Release the tightening nut slightly.
5. Pull the detachable spine out.
6. Unscrew the tightening nut.
7. Pull out the spine extension.
8. The filter is ready for flushing.
9. If the filter discs require acid treatment: separate the element from the spine by loosening the end bolt of the inner cross.

### Assembly

1. Place the discs into position on the disc spine.
2. Turn fixing nut clockwise to tighten discs.
3. Reinsert the detachable spine into its' seat.
4. Again, turn tightening nut clockwise to complete disc tightening.
5. Place filter cover on body.
6. Secure the clamp onto the cover and close using the lever.

### Installation

The twin filter may be installed as a single, manually flushed unit, in a multiple backwash filter battery or as a self-flushing single filter. The two twin filter elements should always be positioned horizontally, whether end connections are pointed vertically or horizontally.

### Maintenance

Filter discs may become covered by lime deposits. If head loss remains high after flushing, Chloric acid treatment of the discs is recommended.

### Part List

No.	Cat. No.	Description	Material
1	5006 0004	Gauge ports seal	EPDM
2	2511 0103	Gauge ports nut	RPP
3	2530 0202	Spine holder	RPA
4	5003 2238	O-ring 2-238	EPDM
5	2502 0212	Spine	RPP
6	2021 1_ _ _	Disc sets	PP
	2031 1_ _ _	Pair disc sets	PP
7	2502 0214	Spine extension	PP
8	2506 0211	Fixing nut	RPP
9	5040 1010	Fastening bolt	SS
10	5042 0030	Clamp	SS
11	5005 0002	Cover seal	EPDM
12	2501 0220	Filter cover	RPA
	2202 0022	Filter cover with 1/2" threaded	
	2501 9220	Transparent filter cover	
13 *	5054 0212	1/2"x1/4" tap / ring	BRASS
14	2510 0325	3" Ring flange (ASA, DIN, BSTD)	RPA
15	2507 0308	Cone flange	POM
16	5005 2013	3" Gasket	EPDM
17	2232 0001	Filter body complex threaded ends	
18	2121 1_ _ _	Single filter element	
	2131 1_ _ _	Double filter element	

(\*) – Optional

### Materials

RPP - Reinforced Polypropylene  
 RPA - Reinforced Polyamide  
 PP - Polypropylene  
 SS -Stainless Steel  
 POM - ACETAL

